

TECH-MCS QUICK START GUIDE

PACKTYPE 5 (16 IMUs)

5 Execute the software TECH MCS STUDIO

Path: Start/Program files/Technaid S.L/ Tech MCS Studio



• Using TECH MCS STUDIO in USB or BLUETOOTH mode

Detect devices automatically (Ctrl+U)

Create a new project (Ctrl+N)

Start/Stop captura (Ctrl+Space)



• Using TECH MCS STUDIO in MICRO SD mode

Detect devices automatically (Ctrl+U)

Configure micro sd card

Capture without your computer with the Start/Stop Button



View Tech MCS STUDIO

1. Toolbar
2. Work/Capture area
3. Help icon
4. Side Toolbar

*Note: For more information, see the software help.



Technaid S.L.
 Avda. de Madrid nº84. - Arganda del Rey
 28500 Madrid - Spain
 Tel / Fax: (+34) 918 71 99 74
 www.technaid.com
 info@technaid.com - support@technaid.com



Read carefully and follow the installation and operating procedures described in this guide for proper operation and to avoid damage to the unit and/or the devices you connect.



Content of the pack:

- a) Briefcase Cloth
- b) Suitcase
- c) 16 Tech IMU CAN
- d) 1 Tech HUB with belt loop
- e) CD with Software Tech MCS Studio / Users Manual
- f) 1 Power adapter (5V@3A)
- g) 4 Rechargeable Batteries (AA NIMH)
- h) 1 Trigger Module (2 components wireless external trigger and trigger hub, optional)
- i) 1 Cable USB
- j) 1 Bluetooth-USB Adapter (2 components antenna and module, optional)
- k) 12 Cables CAN
- l) 16 Textile fastening

*Note: Make sure you identify in Bluetooth and USB mode, the COM port used in the Windows Device Manager and lower its latency to 1ms.

1. General Tech HUB description

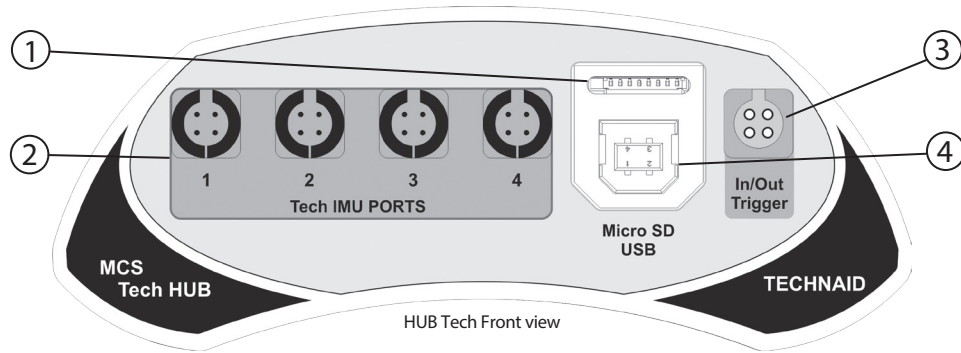

1. Card slot for MICRO SD (included)
2. Tech IMU CAN Ports
3. in/out TRIGGER Port
4. USB Port

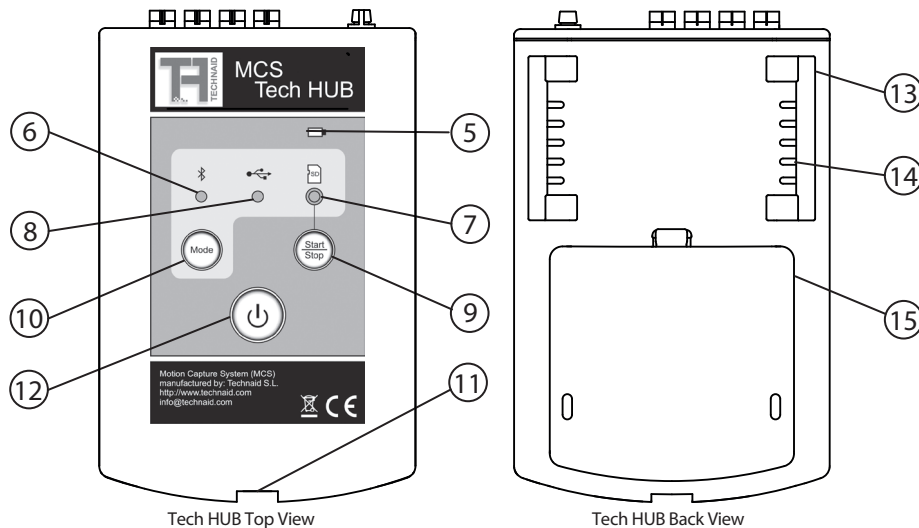

5. LED battery level indicator
6. LED BLUETOOTH mode
7. LED MICRO SD mode
8. LED USB mode
9. Start capture button in MICRO SD mode
10. Button MODE
11. Input direct current (DC)
12. On/Off Button
13. Clamping pins
14. Ventilation
15. Battery compartment

2. Process

1. Connect the power adapter to the Tech HUB device (11) or insert the batteries (15)
2. Connect the Tech IMU you intend to use according to the scheme shown below.

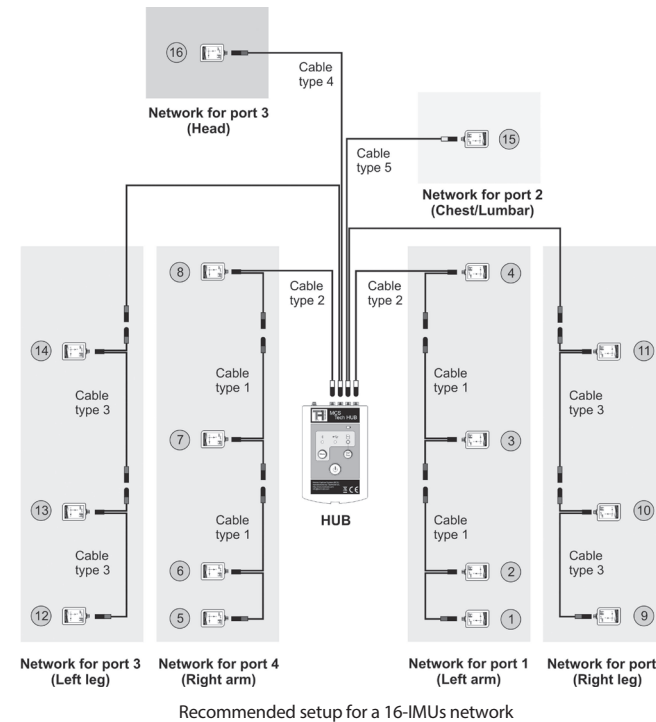

| CABLES | |
|----------------|---------------------------------|
| Type: 1 | Ref: C-C01-01-BR-MCSV3 |
| Type: 2 | Ref: C-C02-01-BRH-MCSV3 |
| Type: 3 | Ref: C-C03-01-PI-MCSV3 |
| Type: 4 | Ref: C-C04-01-PICH-MCSV3 |
| Type: 5 | Ref: C-C05-01-PILH-MCSV3 |

3. Switch on the Tech HUB device (12), wait for beep and select by MODE button (10) the desired operating mode (6, 7, 8).
4. Connect the Tech HUB device to the PC as per selected mode in the step above.
 - USB Mode (8): Connect the device to your computer and start the software Tech MCS STUDIO.
 - Bluetooth Mode (6): Make sure you have plugged the bluetooth adapter to the computer, wait until the indicator light in the Bluetooth mode stops flashing and start the software Tech MCS STUDIO.
 - MICRO SD Mode (7): Connect the Tech HUB device to your computer USB port and configure the MICRO SD card using the software Tech MCS STUDIO.

*Note: For more information consult the user manual.